

1

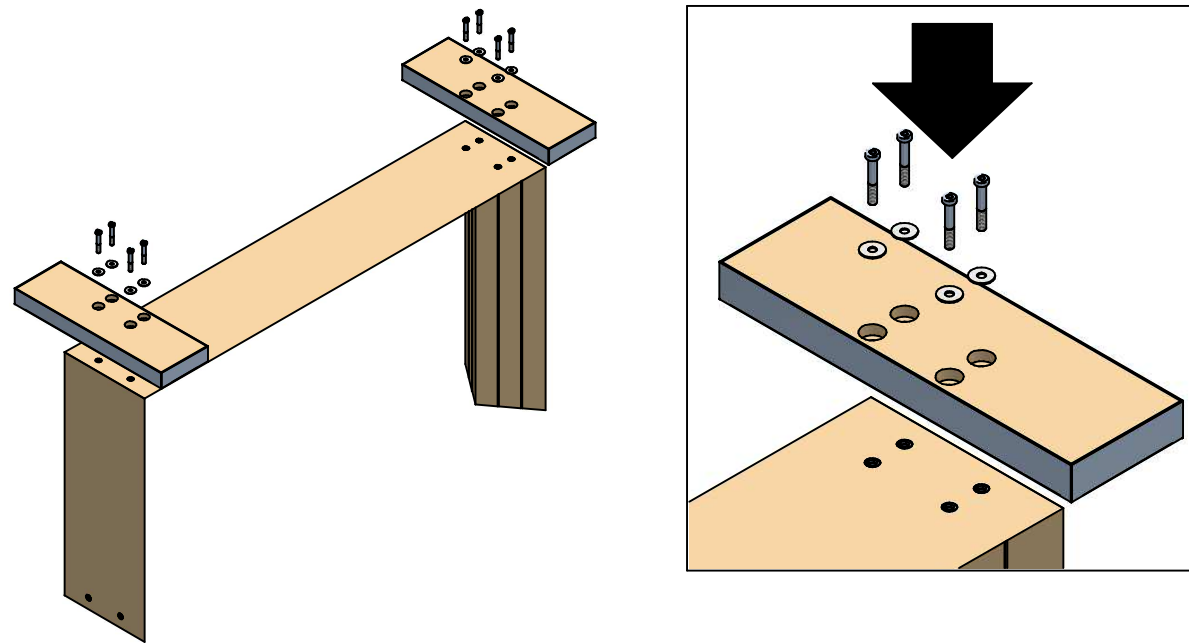

Fissare i piedi.

Fix the legs.

Die Füße befestigen.

Fixer les pieds.

Fijar las patas.

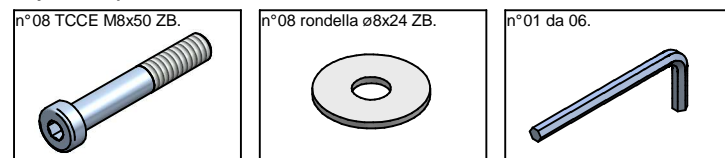

2

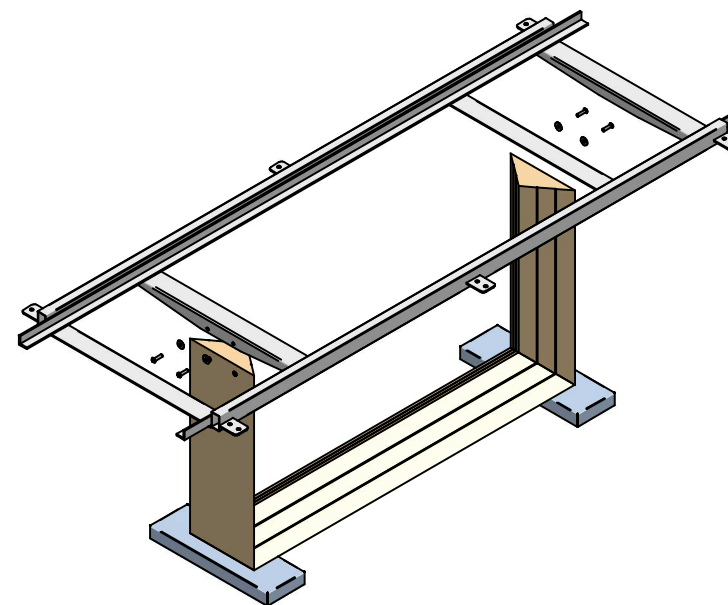

Posizionare la struttura sulla base e fissarla con le apposite viti.

Place the frame on the base and fix it with provided screws.

Die Struktur auf die Basis lehnen und mit den dazugehörigen Schrauben befestigen.

Mette en position le châssis sur la base et le fixer avec les vis en dotation.

Poner la estructura sobre la base y fijarla con los tornillos.

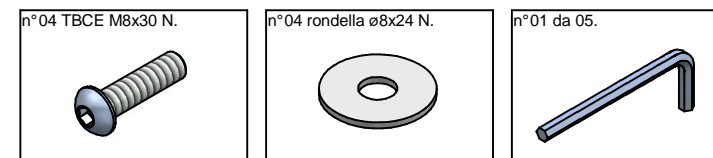

3

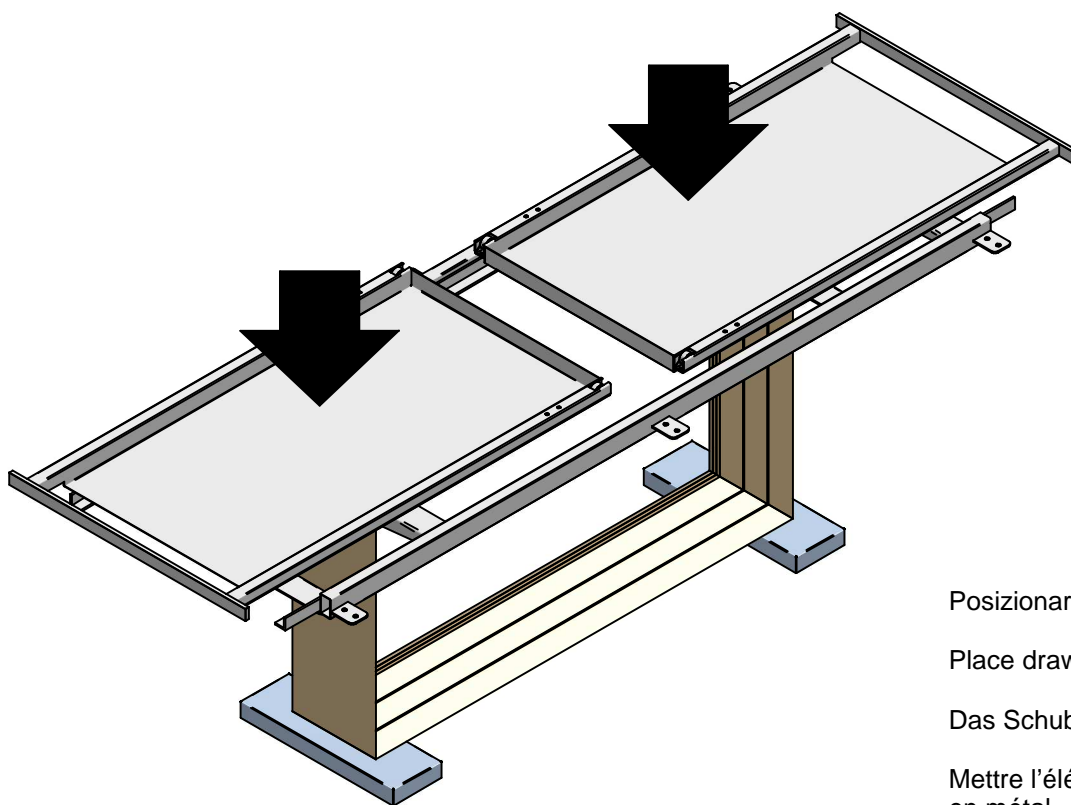

Posizionare i cassetti sulla struttura in metallo.

Place drawers on the metal frame.

Das Schubladenteil auf die Basis lehnen.

Mette l'élément avec les tiroirs sur le châssis en métal.

Poner los cajones sobre la estructura de metal.

4

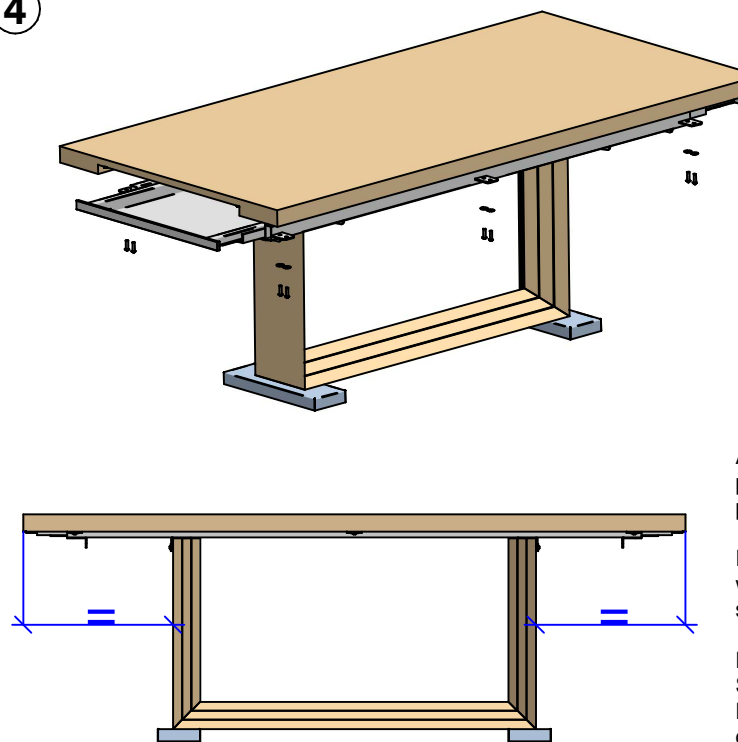

Allungare i cassetti di circa 10 cm, appoggiare il piano sulla struttura e pre-fissare le viti e le rondelle, chiudere i due cassetti e centrare bene il piano alla struttura quindi fissare bene le viti.

Reach drawers out of 10 cm, place the top on the frame, lean screws and washers. Close two drawers, place well the top on the frame and fix well screws.

Die Verlängerungsbasis für zirka 10 cm herausziehen, die Platte auf die Struktur lehnen und die Schrauben und Unterlegscheibe alb-befestigen. Die zwei Verlängerungsbasis schließen, die Tischplatte zentrieren und dann die Schrauben befestigen.

Sortir les tiroirs de 10 cm environ, appuyer le plateau sur le châssis et fixer de façon pas définitive le les vis et les rondelles, fermer les tiroirs et bien centrer le plateau avec la structure, fixer les vis.

Alargar los cajones de 10 cm., poner el piano sobre la estructura y prefijar los tornillos y las rondanas. Cerrar los cajones, centrar bien el piano a la estructura y fijar bien los tornillos.

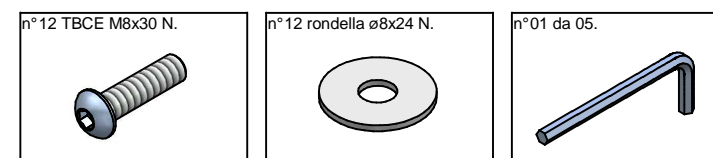

5 160 → 236x90x75h  
220 → 320x106x75h

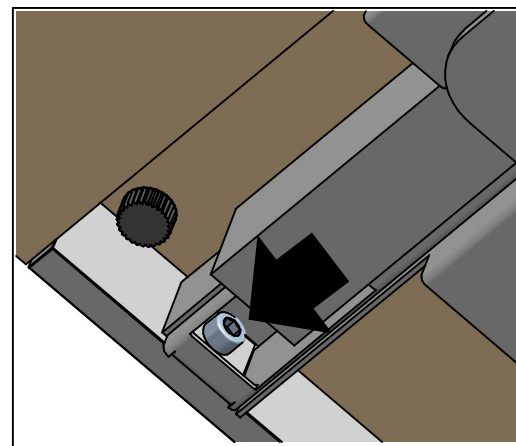
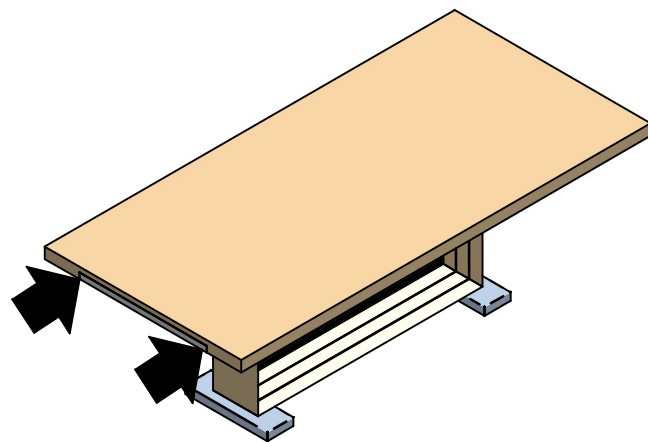

Allentare le viti e regolare la posizione della lama.  
Loosen screws and adjust the blade position.  
Die Schrauben nachlassen und die Stelle der Klinge regeln.  
Desserrer les vis et régler la position de la lame.  
Aflojar los tornillos y regular la posición de la plancha metálica.

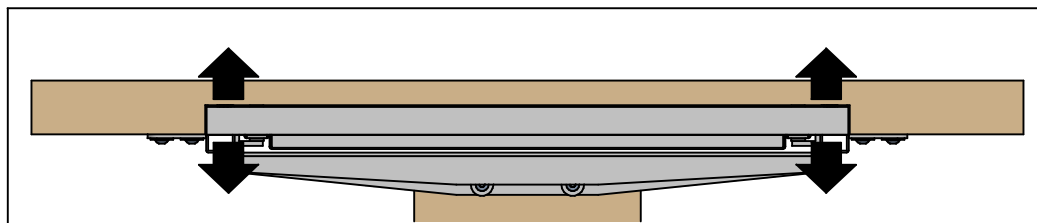

n°01 da 05.



6 160 → 236x90x75h  
220 → 320x106x75h

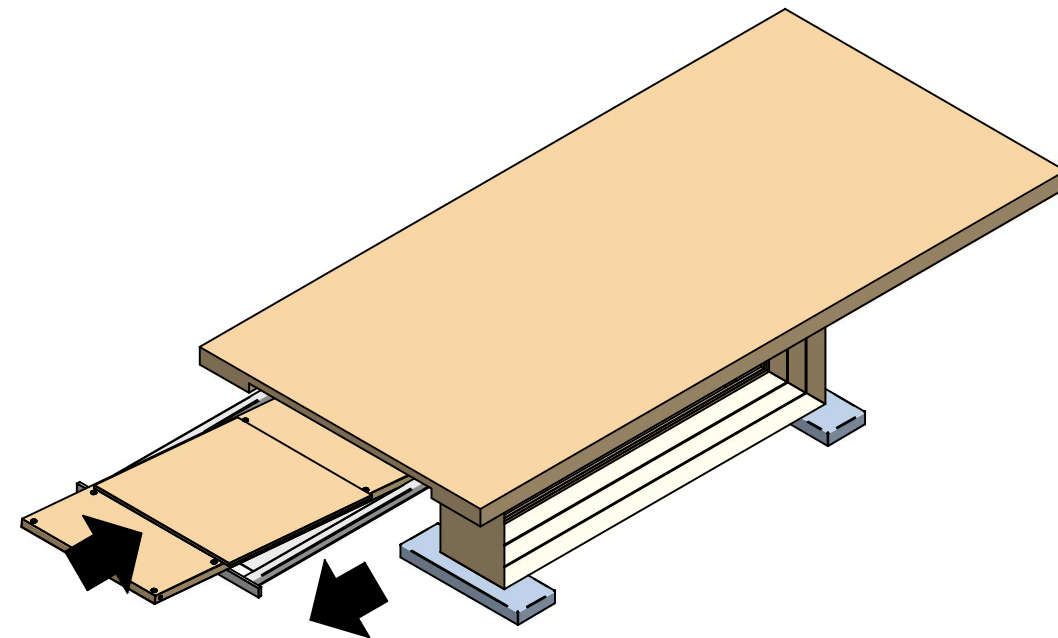

Aprire i cassetti e inserire le allunghe.  
Open drawers and insert leaves.  
Die Verlängerungsbasis herausziehen und die Verlängerungen einlegen.  
Ouvrir les tiroirs et insérer les rallonges.  
Abrir los cajones y introducir las alargaderas.

7 160 → 236x90x75h  
220 → 320x106x75h

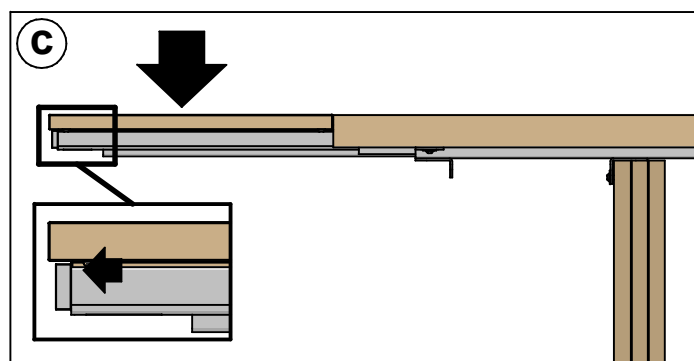
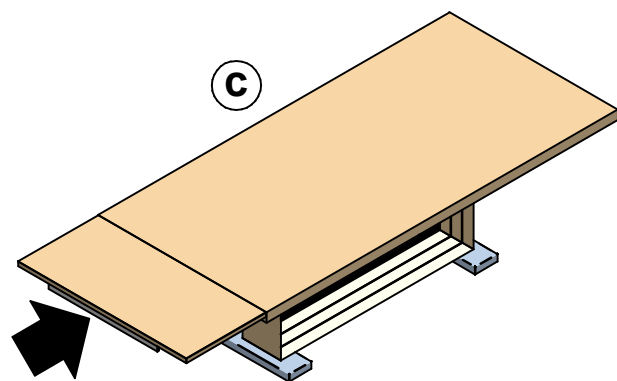
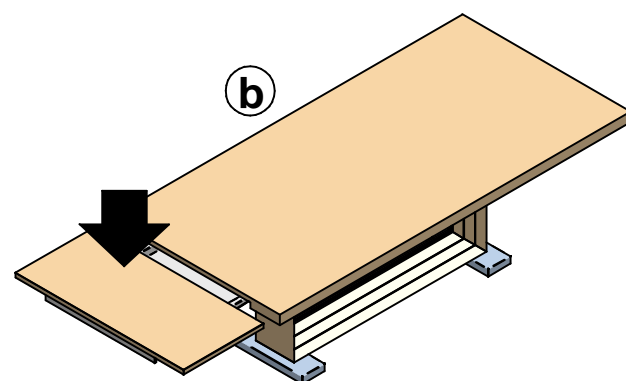
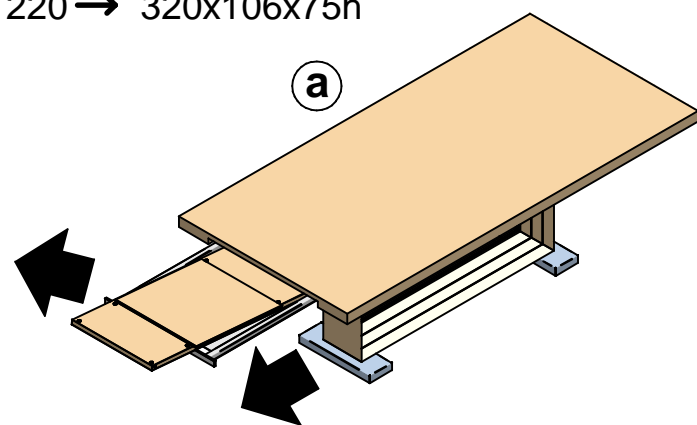

8 160 → 236x90x75h

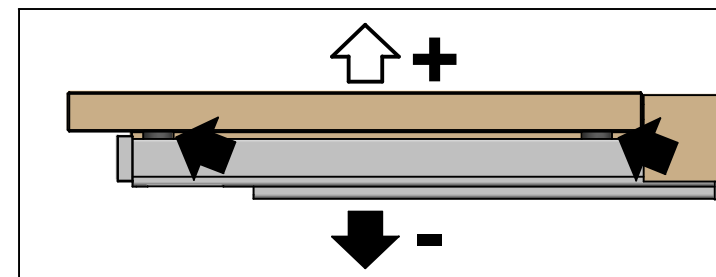
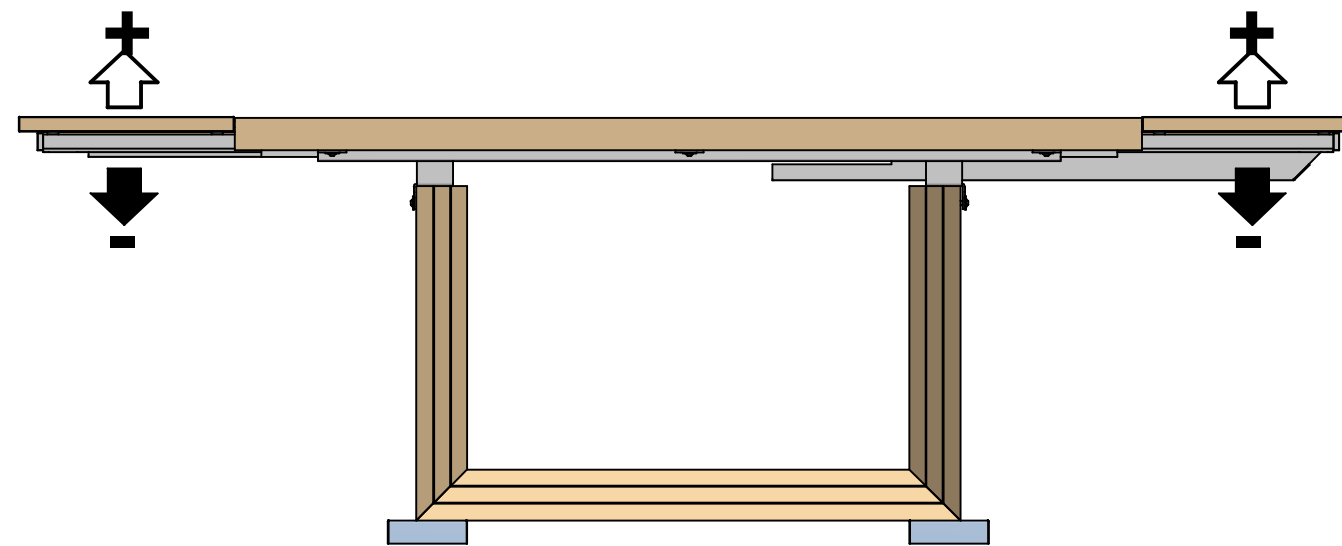

APPOGGI REGOLABILI  
ADJUSTABLE SUPPORTS  
SUPPORTS REGLABLES  
HOEHENVERSTELLBARE AUFLAGESTUTZEN  
APOYO AJUSTABLE