

Molteni & C

HORIZONS — DANTE BONUCCELLI 2020

1—
4



With Horizons, a cupboard for the daytime area, Dante Bonuccelli proposes a different way of storing, and at the same time displaying much-loved objects. Two tip-up doors, which, when closed, reveal the contents thanks to both the transparent stopsol glass and the internal LED lighting, and when open, folded back against the side of the piece for full access to the internal space, transform the sideboard like a chameleon. Inside the exquisitely detailed graphite oak structure, the two suspended drawers and the top shelf, which re-divides the space, are enhanced with calacatta gold marble or glossy lacquered back panels in the colours of the Molteni range. The pewter colour framed and transparent stopsol glass doors are available with or without the graphite oak cross pieces. The former feature asymmetrically placed horizontal profiles, reminiscent of a shed that only partially reveals the inside, increasing curiosity about its contents. Designed as a cupboard for the dining area, thanks also to useful accessories such as the cutlery holder and the Eco Skin drawer bottom, or as a vitrine for precious objects.

DATASHEET

REGISTERED
DESIGN

IX.2021

FINISHES

finishes

graphite oak calacatta gold marble glossy lacquered colours pewter colour transparent stopsol glass ivory Eco Skin

components

| | | | | | | |
|-----------------------------------|------------------|----|---|--|--|--|
| structure/drawers/pull-out shelf | | | | | | |
| additional back panel | | ** | * | | | |
| internal support shelf | * | ** | | | | |
| door | frame | | | | | |
| | horizontal slats | | | | | |
| | glass | | | | | |
| base | | | | | | |
| drawer bottom Eco Skin (optional) | | | | | | |
| internal drawer dividers | | | | | | |

- * With the additional back panel in glossy lacquered colours, the internal support shelf is always in wood
- ** With the additional back in marble, the internal support shelf is always in marble

NOTES

- ▶ No reductions are available, and no modifications can be made with respect to types in the price list.
- ▶ The unit always includes 2 drawers and a lighting system with a remote controlled socket.
- ▶ The lighting system can have two other switch systems (optional): a wireless radio-controlled dimmer unit or a Casambi control unit.
- ▶ The version with the additional back in marble always has the internal support shelf in marble.
- ▶ The version with the additional back in glossy lacquer always has the internal support shelf in the same wood as the structure.
- ▶ The base is equipped with a patented mechanism for opening doors, and a tray that contains the electrical system.
- ▶ Internal drawer measurements: W 108,8-42 7/8" D 37,75-14 7/8" H 9,9-3 7/8"
- ▶ The internal support shelf is always equipped with a schuko socket positioned as described on p. 4.

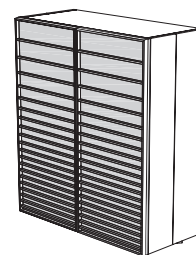
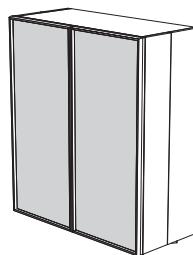

measurements with doors open

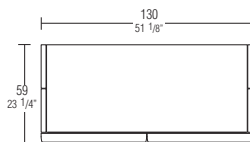

plan - doors closed

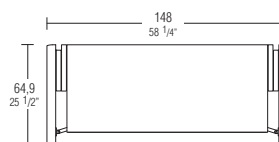

plan - doors open

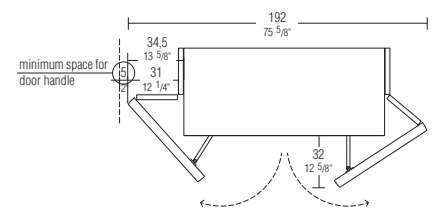

plan - measurements

DATASHEET

REGISTERED
DESIGN

IX.2021

TECHNICAL INFORMATION

STRUCTURE AND DRAWERS

Chipboard panel covered with sliced wood veneer Oak (Quercus).

INTERNAL ADDITIONAL BACK PANEL

In marble or chipboard panel finished in glossy paint in colours from the Molteni range.

TOP

In marble with water-repellent stain resistant treatment or chipboard panel covered with sliced wood veneer oak (Quercus).

GLASS DOORS

Glass doors with frame in painted extruded aluminium, horizontal slats in extruded aluminium covered with sliced wood veneer Oak (Quercus). Tempered transparent stopsol glass.

BASE WITH MECHANISM

Painted metal with parts for mechanisms in other materials.

Molteni & C

3

4

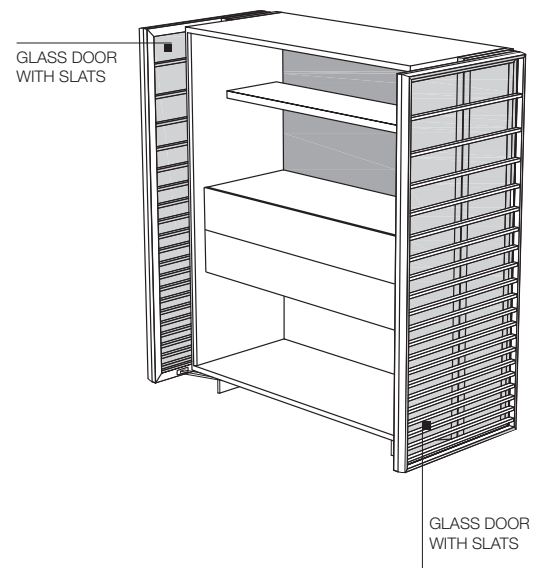
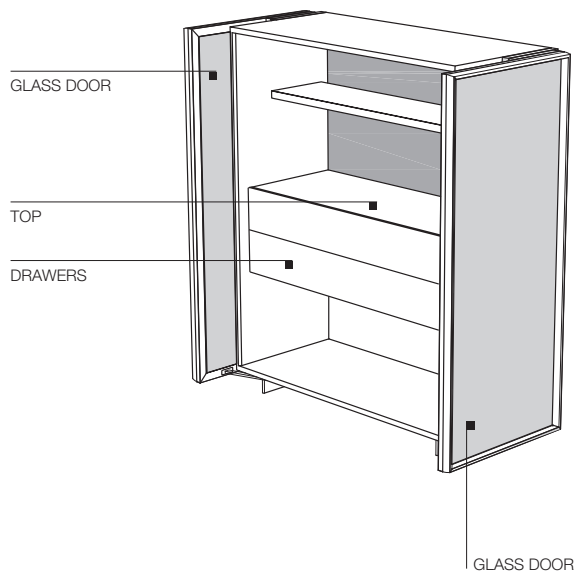

DATASHEET

REGISTERED
DESIGN

IX.2021

DIMENSIONS

**Cupboard
with glossy lacquered
additional back**

MH15/13A

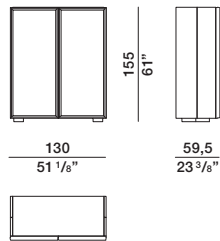

MH15/13B

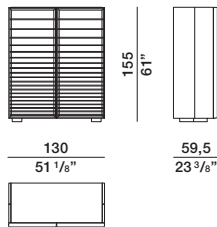

**Cupboard
with additional back
and support shelf
in marble**

MH15/13C

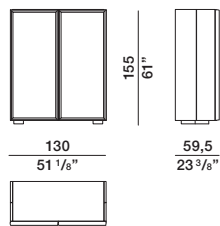

MH15/13D

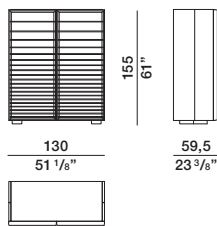

**Drawer
accessories**

**Drawer bottom
in Eco Skin**
W 108,8 D 37,7
W 42 7/8" D 14 7/8"

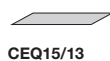

CEQ15/13

**Internal drawer divider
Type A**
W 54 D 37,1 H 9
W 21 1/4" D 14 7/8" H 3 1/2"



CDI15/13A

**Internal drawer divider
Type B**
W 54 D 37,1 H 9
W 21 1/4" D 14 7/8" H 3 1/2"

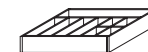

CDI15/13B

Accessories

**Radio control kit
with brightness
setting
(optional)**



EKRR2

**Casambi control unit
(optional)**

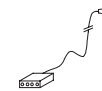

ECC1

**Electrical socket
positioning**

The internal support shelf
is always equipped with a
schuko socket
(220V CE certification)
(pewter colour finish)



± 1,8 with marble panel /
2,2 with glossy lacquered panel

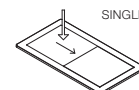

SINGLE

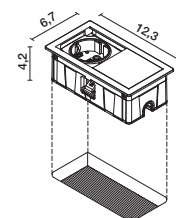

**For countries that use 110V current or where certifications
other than CE certification are required, the shelf will be
supplied without electrical socket and without processing**

DATASHEET

REGISTERED
DESIGN

IX.2021