

Choose the language

English

Italiano

Deutsch

Français

Español

BE-EASY

Sizes

Prof. 79 cm
Depth 31 1/8"

79

123 cm 48 3/8"

 → Fenix-NTM®

123/163/203 cm 48 3/8/64 1/8/79"
--

 → Fenix-NTM®

150 cm 59"

 → Fenix-NTM®

150/190/230 cm 59/74 1/8/90 1/2"
--

 → Fenix-NTM®

Prof. 89 cm
Depth 35"

89

150 cm 59"

 → Fenix-NTM®

150/190/230 cm 59/74 1/8/90 1/2"
--

 → Fenix-NTM®

170 cm 66 7/8"

 → Fenix-NTM®

170/210/250 cm 66 7/8/82 3/4/98 3/8"
--

 → Fenix-NTM®

Prof. 99 cm
Depth 39"

88

200 cm 78 3/8"

 → Fenix-NTM®

200/240/280 cm 78 3/4/94 1/2/110 2/8"

 → Fenix-NTM®

Tops 17 mm thick

Fenix-NTM®

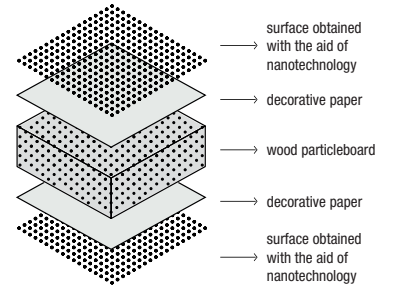
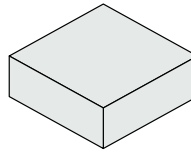

BE-EASY

Extensible - Depth 79 cm

Leg finish:

White lacquered steel (similar to RAL 9016)

"Fenix-NTM® Ottawa beaver" lacquered steel (similar to RAL Design0805010)

"Fenix-NTM® London grey" lacquered steel (similar to RAL Design0805005)

Black lacquered steel (similar to RAL 9004)

Note:

Under-top bars in anodised aluminium.

Reinforced packaging, see inside cover.

Finish of top/extensions:

Kos white 0032 Fenix-NTM®

Ottawa beaver 0717 Fenix-NTM®

London grey 0718 Fenix-NTM®

Ingo black 0720 Fenix-NTM®

Code	Lenght	Legs	Top	pack	m ³	Kg
			Fenix-NTM®			
01BEA01	123-163-203	Lacquered		1	0,27	47
01BEA02	150-190-230	Lacquered		1	0,32	53

Optionals

Code	Description	pack	m ³	Kg
02GTA02	Legs height cut to size	-	-	-

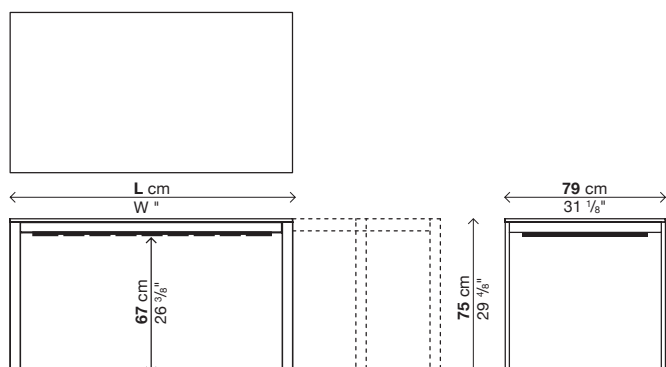

BE-EASY

Fixed - Depth 79 cm

Leg finish:

White lacquered steel (similar to RAL 9016)
 "Fenix-NTM® Ottawa beaver" lacquered steel (similar to RAL Design0805010)
 "Fenix-NTM® London grey" lacquered steel (similar to RAL Design0805005)
 Black lacquered steel (similar to RAL 9004)

Note:

Under-top bars in anodised aluminium.
 Reinforced packaging, see inside cover.

Finish of top:

Kos white 0032 Fenix-NTM®
 Ottawa beaver 0717 Fenix-NTM®
 London grey 0718 Fenix-NTM®
 Ingo black 0720 Fenix-NTM®

Code	Lenght	Legs	Top	pack	m³	Kg
			Fenix-NTM®			
01BEA01F	123	Lacquered		1	0,27	33
01BEA02F	150	Lacquered		1	0,32	38

Optionals

Code	Description	pack	m³	Kg
02GTA02	Legs height cut to size	-	-	-
02FOR03	Lateral or central cable hole Ø6	-	-	-
02RET09	Plastic cable mesh	1	0,07	1
02VER01	Vertebra, opal white methacrylate	1	0,007	1,5
02CPU07	CPU unit, opal white methacrylate	1	0,14	5,5

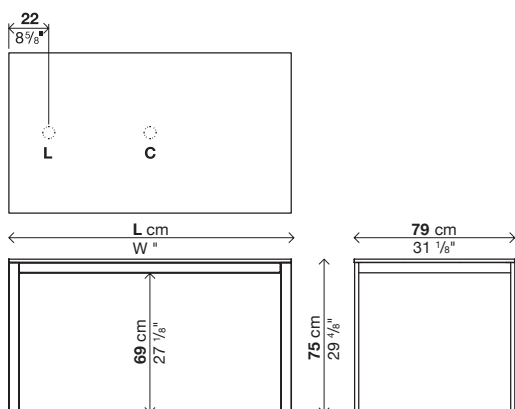

BE-EASY

Extensible - Depth 89 cm

Leg finish:

White lacquered steel (similar to RAL 9016)
"Fenix-NTM® Ottawa beaver" lacquered steel (similar to RAL Design0805010)
"Fenix-NTM® London grey" lacquered steel (similar to RAL Design0805005)
Black lacquered steel (similar to RAL 9004)

Note:

Under-top bars in anodised aluminium.

Reinforced packaging, see inside cover.

Finish of top/extensions:

Kos white 0032 Fenix-NTM®
Ottawa beaver 0717 Fenix-NTM®
London grey 0718 Fenix-NTM®
Ingo black 0720 Fenix-NTM®

Code	Lenght	Legs	Top	pack	m ³	Kg
			Fenix-NTM®			
01BEA05	150-190-230	Lacquered		1	0,36	62
01BEA03	170-210-250	Lacquered		1	0,37	76

Optionals

Code	Description	pack	m ³	Kg
02GTA02	Legs height cut to size	-	-	-

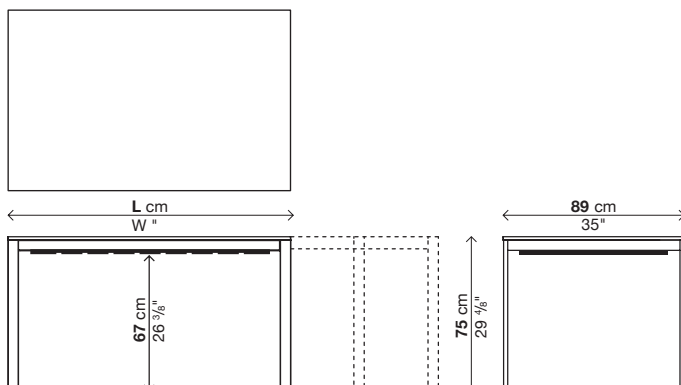

BE-EASY

Fixed - Depth 89 cm

Leg finish:

White lacquered steel (similar to RAL 9016)
 "Fenix-NTM® Ottawa beaver" lacquered steel (similar to RAL Design0805010)
 "Fenix-NTM® London grey" lacquered steel (similar to RAL Design0805005)
 Black lacquered steel (similar to RAL 9004)

Note:

Under-top bars in anodised aluminium.
 Reinforced packaging, see inside cover.

Finish of top:

Kos white 0032 Fenix-NTM®
 Ottawa beaver 0717 Fenix-NTM®
 London grey 0718 Fenix-NTM®
 Ingo black 0720 Fenix-NTM®

Code	Lenght	Legs	Top	pack	m³	Kg
			Fenix-NTM®			
01BEA05F	150	Lacquered		1	0,36	40
01BEA03F	170	Lacquered		1	0,37	45

Optionals

Code	Description	pack	m³	Kg
02GTA02	Legs height cut to size	-	-	-
02FOR03	Lateral or central cable hole Ø6	-	-	-
02RET02	Plastic cable mesh	1	0,07	1
02VER01	Vertebra, opal white methacrylate	1	0,007	1,5
02CPU08	CPU unit, opal white methacrylate	1	0,14	5,5

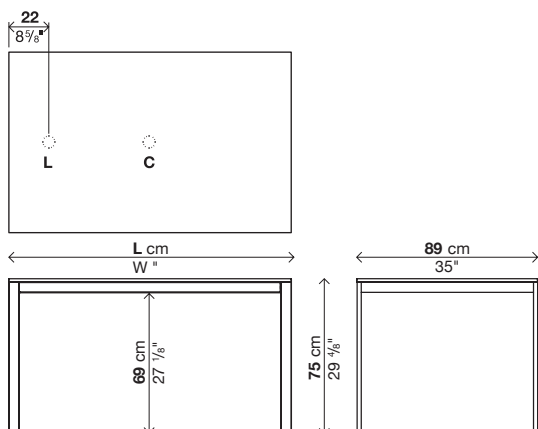

BE-EASY

Extensible - Depth 99 cm

Leg finish:

White lacquered steel (similar to RAL 9016)
 "Fenix-NTM® Ottawa beaver" lacquered steel (similar to RAL Design0805010)
 "Fenix-NTM® London grey" lacquered steel (similar to RAL Design0805005)
 Black lacquered steel (similar to RAL 9004)

Note:

Under-top bars in anodised aluminium.

Reinforced packaging, see inside cover.

Finish of top/extensions:

Kos white 0032 Fenix-NTM®
 Ottawa beaver 0717 Fenix-NTM®
 London grey 0718 Fenix-NTM®
 Ingo black 0720 Fenix-NTM®

Code	Lenght	Legs	Top	pack	m ²	Kg
			Fenix-NTM®			
01BEA04	200-240-280	Lacquered		1	0,5	76

Optionals

Code	Description	pack	m ²	Kg
02GTA02	Legs height cut to size	-	-	-

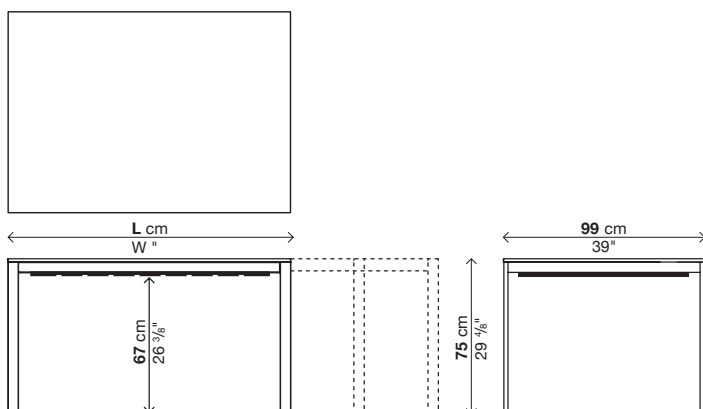

BE-EASY

Fixed - Depth 99 cm

Leg finish:

White lacquered steel (similar to RAL 9016)

"Fenix-NTM® Ottawa beaver" lacquered steel (similar to RAL Design0805010)

"Fenix-NTM® London grey" lacquered steel (similar to RAL Design0805005)

Black lacquered steel (similar to RAL 9004)

Note:

Under-top bars in anodised aluminium.

Reinforced packaging, see inside cover.

Finish of top:

Kos white 0032 Fenix-NTM®

Ottawa beaver 0717 Fenix-NTM®

London grey 0718 Fenix-NTM®

Ingo black 0720 Fenix-NTM®

Code	Lenght	Legs	Top	pack	m ³	Kg
			Fenix-NTM®			
01BEA04F	200	Lacquered		1	0,5	58

Optionals

Code	Description	pack	m ³	Kg
02GTA02	Legs height cut to size	-	-	-
02FOR03	Lateral or central cable hole Ø6	-	-	-
02RET03	Plastic cable mesh	1	0,07	1
02VER01	Vertebra, opal white methacrylate	1	0,007	1,5

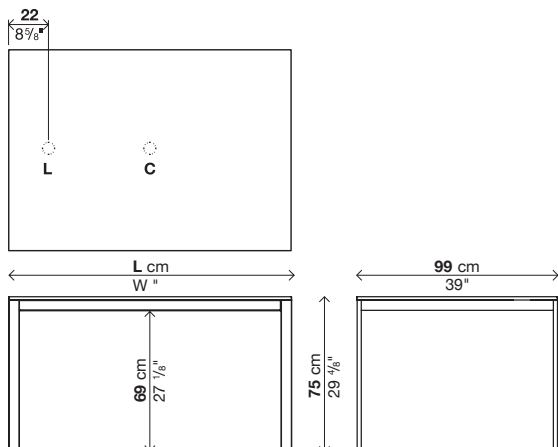

BE-EASY

Legenda dimensioni

	Prof. 79 cm Depth 31 1/8"		Prof. 89 cm Depth 35"		Prof. 99 cm Depth 39"			
79	123 cm 48 3/8"	→ Fenix-NTM®	89	150 cm 59"	→ Fenix-NTM®	89	200 cm 78 3/8"	→ Fenix-NTM®
	123/163/203 cm 48 3/8/64 1/8/79"	→ Fenix-NTM®		150/190/230 cm 59/74 1/8/90 1/2"	→ Fenix-NTM®		200/240/280 cm 78 3/4/94 1/2/110 2/8"	→ Fenix-NTM®
	150 cm 59"	→ Fenix-NTM®		170 cm 66 7/8"	→ Fenix-NTM®			
	150/190/230 cm 59/74 1/8/90 1/2"	→ Fenix-NTM®		170/210/250 cm 66 7/8/82 3/4/98 3/8"	→ Fenix-NTM®			

Piani Sp. 17 mm

Fenix-NTM®

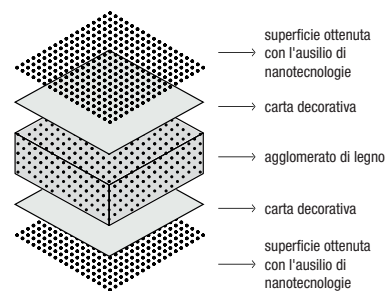
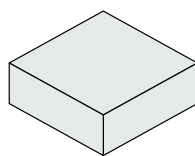

BE-EASY

Allungabile - Profondità 79 cm

Finitura gambe:

Acciaio verniciato bianco (simile al RAL 9016)

Acciaio verniciato "Fenix-NTM® castoro Ottawa" (simile al RAL Design0805010)

Acciaio verniciato "Fenix-NTM® grigio Londra" (simile al RAL Design0805005)

Acciaio verniciato nero (simile al RAL 9004)

Finitura piano/prolunghe:

Fenix-NTM® bianco Kos 0032

Fenix-NTM® castoro Ottawa 0717

Fenix-NTM® grigio Londra 0718

Fenix-NTM® nero Ingo 0720

Note:

Trafile sottopiano in alluminio anodizzato.

Imballi rinforzati vedi interno di copertina.

Codice	Lunghezza	Gambe	Piano	colli	m ³	Kg
			Fenix-NTM®			
01BEA01	123-163-203	Verniciato		1	0,27	47
01BEA02	150-190-230	Verniciato		1	0,32	53

Optionals

Codice	Descrizione	colli	m ³	Kg
02GTA02	Taglio gambe a misura	-	-	-

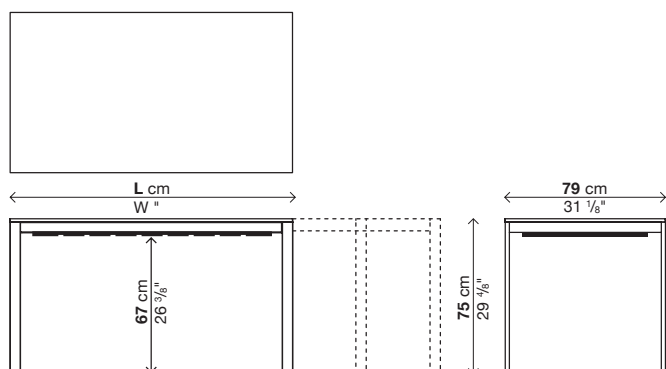

BE-EASY

Fisso - Profondità 79 cm

Finitura gambe:

Acciaio verniciato bianco (simile al RAL 9016)

Acciaio verniciato "Fenix-NTM® castoro Ottawa" (simile al RAL Design0805010)

Acciaio verniciato "Fenix-NTM® grigio Londra" (simile al RAL Design0805005)

Acciaio verniciato nero (simile al RAL 9004)

Note:

Trafile sottopiano in alluminio anodizzato.

Imballi rinforzati vedi interno di copertina.

Finitura piano:

Fenix-NTM® bianco Kos 0032

Fenix-NTM® castoro Ottawa 0717

Fenix-NTM® grigio Londra 0718

Fenix-NTM® nero Ingo 0720

Codice	Lunghezza	Gambe	Piano	colli	m ³	Kg
			Fenix-NTM®			
01BEA01F	123	Verniciato		1	0,27	33
01BEA02F	150	Verniciato		1	0,32	38

Optionals

Codice	Descrizione	colli	m ³	Kg
02GTA02	Taglio gambe a misura	-	-	-
02FOR03	Foro passacavi laterale o centrale Ø6	-	-	-
02RET09	Rete cablaggio in materiale plastico	1	0,07	1
02VER01	Vertebra metacrilato opalino	1	0,007	1,5
02CPU07	Porta CPU in metacrilato opalino	1	0,14	5,5

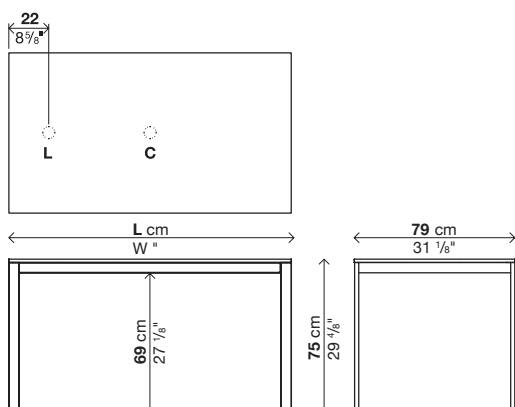

BE-EASY

Allungabile - Profondità 89 cm

Finitura gambe:

Acciaio verniciato bianco (simile al RAL 9016)

Acciaio verniciato "Fenix-NTM® castoro Ottawa" (simile al RAL Design0805010)

Acciaio verniciato "Fenix-NTM® grigio Londra" (simile al RAL Design0805005)

Acciaio verniciato nero (simile al RAL 9004)

Finitura piano/prolunghe:

Fenix-NTM® bianco Kos 0032

Fenix-NTM® castoro Ottawa 0717

Fenix-NTM® grigio Londra 0718

Fenix-NTM® nero Ingo 0720

Note:

Trafile sottopiano in alluminio anodizzato.

Imballi rinforzati vedi interno di copertina.

Codice	Lunghezza	Gambe	Piano	colli	m ³	Kg
			Fenix-NTM®			
01BEA05	150-190-230	Verniciato		1	0,36	62
01BEA03	170-210-250	Verniciato		1	0,37	76

Optionals

Codice	Descrizione	colli	m ³	Kg
02GTA02	Taglio gambe a misura	-	-	-

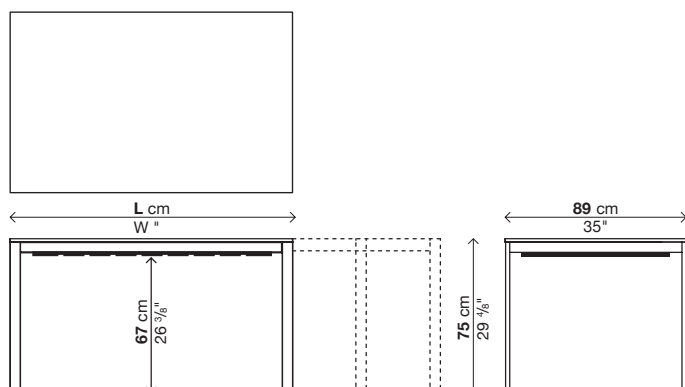

BE-EASY

Fisso - Profondità 89 cm

Finitura gambe:

Acciaio verniciato bianco (simile al RAL 9016)

Acciaio verniciato "Fenix-NTM® castoro Ottawa" (simile al RAL Design0805010)

Acciaio verniciato "Fenix-NTM® grigio Londra" (simile al RAL Design0805005)

Acciaio verniciato nero (simile al RAL 9004)

Note:

Trafile sottopiano in alluminio anodizzato.

Imballi rinforzati vedi interno di copertina.

Finitura piano:

Fenix-NTM® bianco Kos 0032

Fenix-NTM® castoro Ottawa 0717

Fenix-NTM® grigio Londra 0718

Fenix-NTM® nero Ingo 0720

Codice	Lunghezza	Gambe	Piano	colli	m ³	Kg
			Fenix-NTM®			
01BEA05F	150	Verniciato		1	0,36	40
01BEA03F	170	Verniciato		1	0,37	45

Optionals

Codice	Descrizione	colli	m ³	Kg
02GTA02	Taglio gambe a misura	-	-	-
02FOR03	Foro passacavi laterale o centrale Ø6	-	-	-
02RET02	Rete cablaggio in materiale plastico	1	0,07	1
02VER01	Vertebra metacrilato opalino	1	0,007	1,5
02CPU08	Porta CPU in metacrilato opalino	1	0,14	5,5

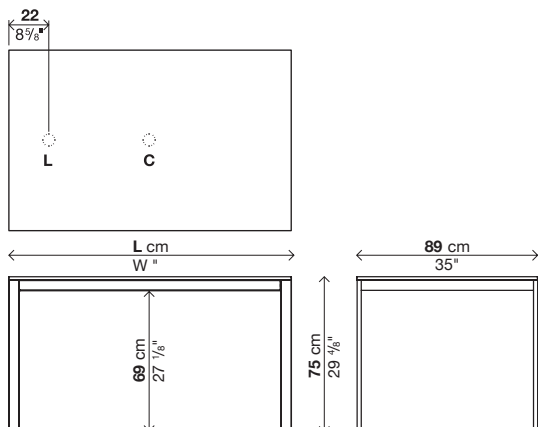

BE-EASY

Allungabile - Profondità 99 cm

Finitura gambe:

Acciaio verniciato bianco (simile al RAL 9016)

Acciaio verniciato "Fenix-NTM® castoro Ottawa" (simile al RAL Design0805010)

Acciaio verniciato "Fenix-NTM® grigio Londra" (simile al RAL Design0805005)

Acciaio verniciato nero (simile al RAL 9004)

Finitura piano/prolunghe:

Fenix-NTM® bianco Kos 0032

Fenix-NTM® castoro Ottawa 0717

Fenix-NTM® grigio Londra 0718

Fenix-NTM® nero Ingo 0720

Note:

Trafile sottopiano in alluminio anodizzato.

Imballi rinforzati vedi interno di copertina.

Codice	Lunghezza	Gambe	Piano	colli	m ²	Kg
			Fenix-NTM®			
01BEA04	200-240-280	Verniciato		1	0,5	76

Optionals

Codice	Descrizione	colli	m ²	Kg
02GTA02	Taglio gambe a misura	-	-	-

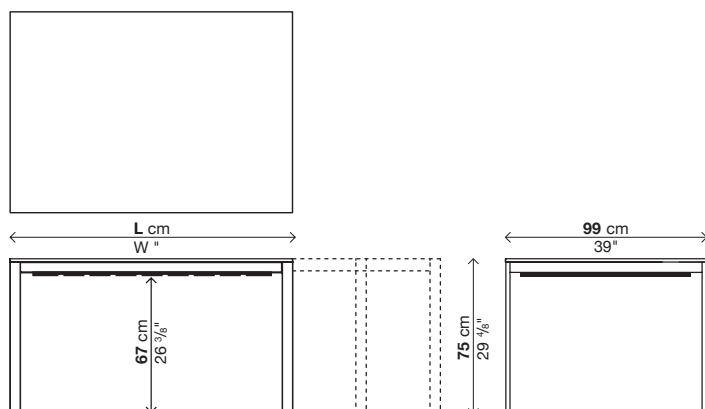

BE-EASY

Übersicht

Prof. 79 cm
Depth 31 1/8"

79

123 cm 48 3/8"

 → Fenix-NTM®

123/163/203 cm 48 3/8/64 1/8/79"
--

 → Fenix-NTM®

150 cm 59"

 → Fenix-NTM®

150/190/230 cm 59/74 1/8/90 1/2"
--

 → Fenix-NTM®

Prof. 89 cm
Depth 35"

89

150 cm 59"

 → Fenix-NTM®

150/190/230 cm 59/74 1/8/90 1/2"
--

 → Fenix-NTM®

170 cm 66 7/8"

 → Fenix-NTM®

170/210/250 cm 66 7/8/82 3/4/98 3/8"
--

 → Fenix-NTM®

Prof. 99 cm
Depth 39"

88

200 cm 78 3/8"

 → Fenix-NTM®

200/240/280 cm 78 3/4/94 1/2/110 2/8"

 → Fenix-NTM®

Platten St. 17 mm

Fenix-NTM®

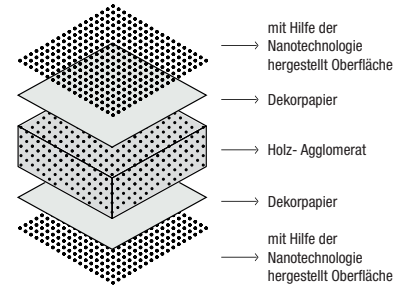
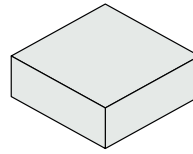

BE-EASY

Erweiterbar - Tiefe 79 cm

Ausführung der Beine:

Weiß lackierter Stahl (farbähnlich wie RAL 9016)

Lackierter Stahl "Fenix-NTM® Biberbraun Ottawa" (farbähnlich wie RAL Design0805010)

Lackierter Stahl "Fenix-NTM® Grau London" (farbähnlich wie RAL Design0805005)

Schwarz lackierter Stahl (farbähnlich wie RAL 9004)

Anmerkung:

Längsstreben unter der Tischplatte aus eloxiertem Aluminium.

Für verstärkte Verpackungen siehe Innenseite des Umschlags.

Ausführung der Platte/Verlängerungen:

Fenix-NTM® Weiß Kos 0032

Fenix-NTM® Biberbraun Ottawa 0717

Fenix-NTM® Grau London 0718

Fenix-NTM® Schwarz Ingo 0720

Art.-Nr.	Länge	Beine	Platte	kolli	m ³	Kg
			Fenix-NTM®			
01BEA01	123-163-203	Lackiert		1	0,27	47
01BEA02	150-190-230	Lackiert		1	0,32	53

Optionen

Art.-Nr.	Beschreibung	kolli	m ³	Kg
02GTA02	Zuschnitt der Beine nach Maß	-	-	-

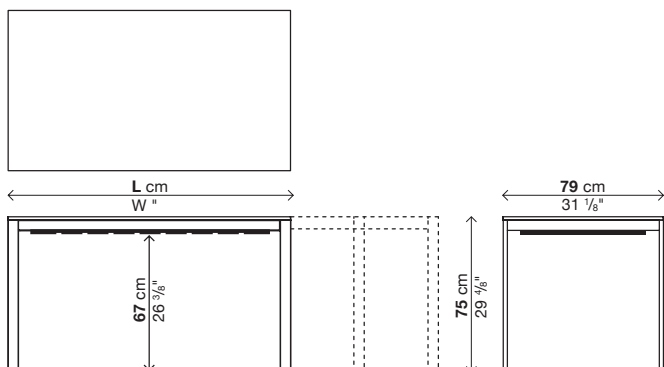

BE-EASY

Fixmaße - Tiefe 79 cm

Ausführung der Beine:

Weiß lackierter Stahl (farbähnlich wie RAL 9016)

Lackierter Stahl "Fenix-NTM® Biberbraun Ottawa" (farbähnlich wie RAL Design0805010)

Lackierter Stahl "Fenix-NTM® Grau London" (farbähnlich wie RAL Design0805005)

Schwarz lackierter Stahl (farbähnlich wie RAL 9004)

Anmerkung:

Längsstreben unter der Tischplatte aus eloxiertem Aluminium.

Für verstärkte Verpackungen siehe Innenseite des Umschlags.

Ausführung der Platte:

Fenix-NTM® Weiß Kos 0032

Fenix-NTM® Biberbraun Ottawa 0717

Fenix-NTM® Grau London 0718

Fenix-NTM® Schwarz Ingo 0720

Art.-Nr.	Länge	Beine	Platte	kolli	m³	Kg
			Fenix-NTM®			
01BEA01F	123	Lackiert		1	0,27	33
01BEA02F	150	Lackiert		1	0,32	38

Optionen

Art.-Nr.	Beschreibung	kolli	m³	Kg
02GTA02	Zuschnitt der Beine nach Maß	-	-	-
02FOR03	Seitlicher oder mittlerer Kabeldurchlass	-	-	-
02RET09	Kabelnetz, Kunststoffmaterial	1	0,07	1
02VER01	Kabelschlange, mattes Methacrylat	1	0,007	1,5
02CPU07	CPU-Träger, mattes Methacrylat	1	0,14	5,5

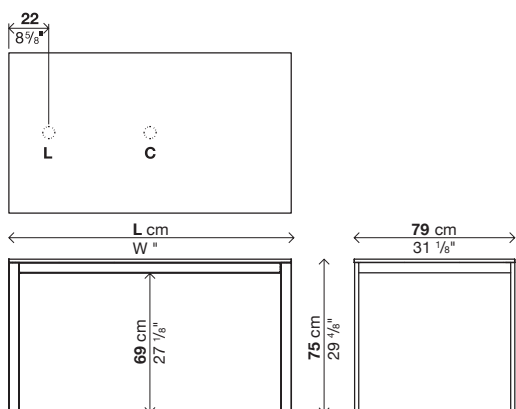

BE-EASY

Erweiterbar - Tiefe 89 cm

Ausführung der Beine:

Weiß lackierter Stahl (farbähnlich wie RAL 9016)

Lackierter Stahl "Fenix-NTM® Biberbraun Ottawa" (farbähnlich wie RAL Design0805010)

Lackierter Stahl "Fenix-NTM® Grau London" (farbähnlich wie RAL Design0805005)

Schwarz lackierter Stahl (farbähnlich wie RAL 9004)

Anmerkung:

Längsstreben unter der Tischplatte aus eloxiertem Aluminium.

Für verstärkte Verpackungen siehe Innenseite des Umschlags.

Ausführung der Platte/Verlängerungen:

Fenix-NTM® Weiß Kos 0032

Fenix-NTM® Biberbraun Ottawa 0717

Fenix-NTM® Grau London 0718

Fenix-NTM® Schwarz Ingo 0720

Art.-Nr.	Länge	Beine	Platte	kolli	m ³	Kg
			Fenix-NTM®			
01BEA05	150-190-230	Lackiert		1	0,36	62
01BEA03	170-210-250	Lackiert		1	0,37	76

Optionen

Art.-Nr.	Beschreibung	kolli	m ³	Kg
02GTA02	Zuschnitt der Beine nach Maß	-	-	-

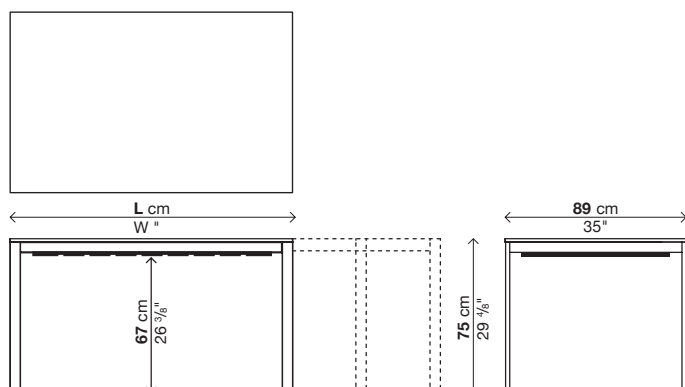

BE-EASY

Fixmaße - Tiefe 89 cm

Ausführung der Beine:

Weiß lackierter Stahl (farbähnlich wie RAL 9016)

Lackierter Stahl "Fenix-NTM® Biberbraun Ottawa" (farbähnlich wie RAL Design0805010)

Lackierter Stahl "Fenix-NTM® Grau London" (farbähnlich wie RAL Design0805005)

Schwarz lackierter Stahl (farbähnlich wie RAL 9004)

Anmerkung:

Längsstreben unter der Tischplatte aus eloxiertem Aluminium.

Für verstärkte Verpackungen siehe Innenseite des Umschlags.

Ausführung der Platte:

Fenix-NTM® Weiß Kos 0032

Fenix-NTM® Biberbraun Ottawa 0717

Fenix-NTM® Grau London 0718

Fenix-NTM® Schwarz Ingo 0720

Art.-Nr.	Länge	Beine	Platte	kolli	m ³	Kg
			Fenix-NTM®			
01BEA05F	150	Lackiert		1	0,36	40
01BEA03F	170	Lackiert		1	0,37	45

Optionen

Art.-Nr.	Beschreibung	kolli	m ³	Kg
02GTA02	Zuschnitt der Beine nach Maß	-	-	-
02FOR03	Seitlicher oder mittlerer Kabeldurchlass	-	-	-
02RET02	Kabelnetz, Kunststoffmaterial	1	0,07	1
02VER01	Kabelschlange, mattes Methacrylat	1	0,007	1,5
02CPU08	CPU-Träger, mattes Methacrylat	1	0,14	5,5

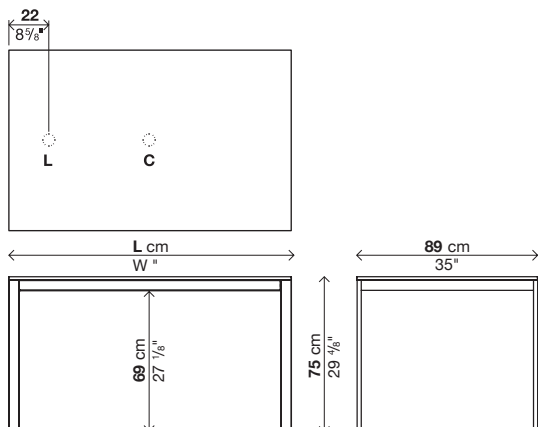

BE-EASY

Erweiterbar - Tiefe 99 cm

Ausführung der Beine:

Weiß lackierter Stahl (farbähnlich wie RAL 9016)
Lackierter Stahl "Fenix-NTM® Biberbraun Ottawa" (farbähnlich wie RAL Design0805010)
Lackierter Stahl "Fenix-NTM® Grau London" (farbähnlich wie RAL Design0805005)
Schwarz lackierter Stahl (farbähnlich wie RAL 9004)

Anmerkung:

Längsstreben unter der Tischplatte aus eloxiertem Aluminium.

Für verstärkte Verpackungen siehe Innenseite des Umschlags.

Ausführung der Platte/Verlängerungen:

Fenix-NTM® Weiß Kos 0032
Fenix-NTM® Biberbraun Ottawa 0717
Fenix-NTM® Grau London 0718
Fenix-NTM® Schwarz Ingo 0720

Art.-Nr.	Länge	Beine	Platte	kolli	m ²	Kg
			Fenix-NTM®			
01BEA04	200-240-280	Lackiert		1	0,5	76

Optionen

Art.-Nr.	Beschreibung	kolli	m ²	Kg
02GTA02	Zuschnitt der Beine nach Maß	-	-	-

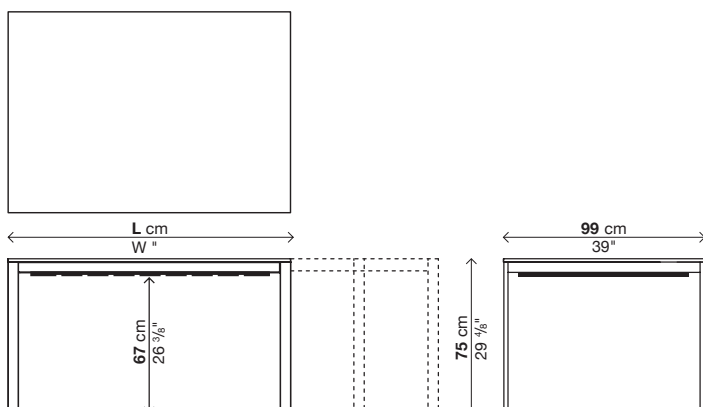

BE-EASY

Fixmaße - Tiefe 99 cm

Ausführung der Beine:

Weiß lackierter Stahl (farbähnlich wie RAL 9016)

Lackierter Stahl "Fenix-NTM® Biberbraun Ottawa" (farbähnlich wie RAL Design0805010)

Lackierter Stahl "Fenix-NTM® Grau London" (farbähnlich wie RAL Design0805005)

Schwarz lackierter Stahl (farbähnlich wie RAL 9004)

Ausführung der Platte:

Fenix-NTM® Weiß Kos 0032

Fenix-NTM® Biberbraun Ottawa 0717

Fenix-NTM® Grau London 0718

Fenix-NTM® Schwarz Ingo 0720

Anmerkung:

Längsstreben unter der Tischplatte aus eloxiertem Aluminium.

Für verstärkte Verpackungen siehe Innenseite des Umschlags.

Art.-Nr.	Länge	Beine	Platte	kolli	m ³	Kg
			Fenix-NTM®			
01BEA04F	200	Lackiert		1	0,5	58

Optionen

Art.-Nr.	Beschreibung	kolli	m ³	Kg
02GTA02	Zuschnitt der Beine nach Maß	-	-	-
02FOR03	Seitlicher oder mittlerer Kabeldurchlass	-	-	-
02RET03	Kabelnetz, Kunststoffmaterial	1	0,07	1
02VER01	Kabelschlange, mattes Methacrylat	1	0,007	1,5

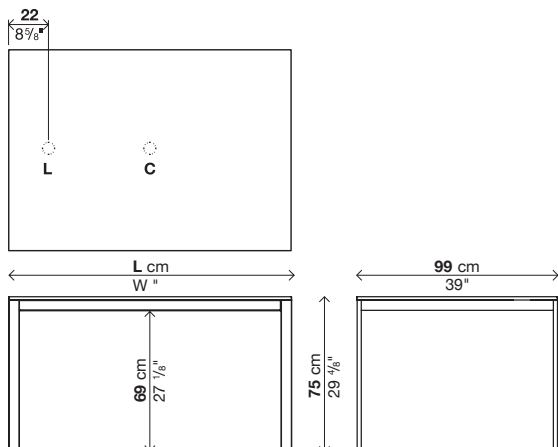

BE-EASY

Dimensions

Prof. 79 cm
Depth 31 1/8"

79

123 cm 48 3/8"

 → Fenix-NTM®

123/163/203 cm 48 3/8/64 1/8/79"
--

 → Fenix-NTM®

150 cm 59"

 → Fenix-NTM®

150/190/230 cm 59/74 1/8/90 1/2"
--

 → Fenix-NTM®

Prof. 89 cm
Depth 35"

89

150 cm 59"

 → Fenix-NTM®

150/190/230 cm 59/74 1/8/90 1/2"
--

 → Fenix-NTM®

170 cm 66 7/8"

 → Fenix-NTM®

170/210/250 cm 66 7/8/82 3/4/98 3/8"
--

 → Fenix-NTM®

Prof. 99 cm
Depth 39"

88

200 cm 78 3/8"

 → Fenix-NTM®

200/240/280 cm 78 3/4/94 1/2/110 2/8"

 → Fenix-NTM®

Plateaux Ép. 17 mm

Fenix-NTM®

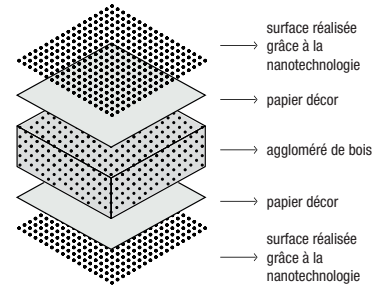
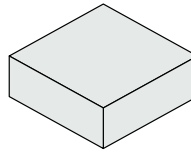

BE-EASY

Extensible - Profondeur 79 cm

Finition piètement:

Acier laqué blanc (semblable à la teinte RAL 9016)

Acier laqué "Fenix-NTM® castor Ottawa" (semblable à la teinte RAL Design0805010)

Acier laqué "Fenix-NTM® gris Londres" (semblable à la teinte RAL Design0805005)

Acier laqué noir (semblable à la teinte RAL 9004)

Finition du plateau/rallonges:

Fenix-NTM® blanc Kos 0032

Fenix-NTM® castor Ottawa 0717

Fenix-NTM® gris Londres 0718

Fenix-NTM® noir Ingo 0720

Notes:

Traverses sous-plateau en aluminium anodisé

Emballages renforcés, voir intérieur de la couverture.

Code	Longueur	Pieds	Plateau	colis	m ³	Kg
			Fenix-NTM®			
01BEA01	123-163-203	Laqué		1	0,27	47
01BEA02	150-190-230	Laqué		1	0,32	53

Optionals

Code	Description	colis	m ³	Kg
02GTA02	Coupe des pieds sur mesure	-	-	-

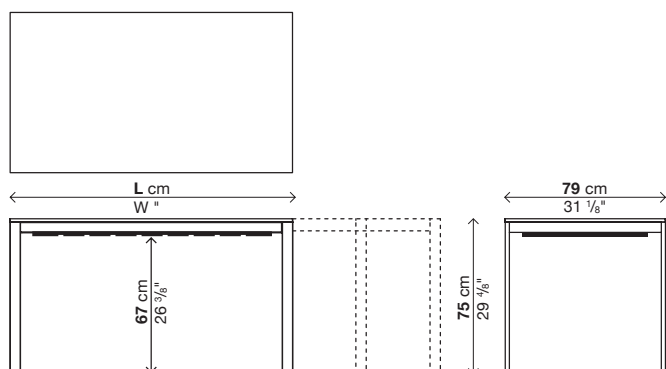

BE-EASY

Fixe - Profondeur 79 cm

Finition piètement:

Acier laqué blanc (semblable à la teinte RAL 9016)

Acier laqué "Fenix-NTM® castor Ottawa" (semblable à la teinte RAL Design0805010)

Acier laqué "Fenix-NTM® gris Londres" (semblable à la teinte RAL Design0805005)

Acier laqué noir (semblable à la teinte RAL 9004)

Finition du plateau:

Fenix-NTM® blanc Kos 0032

Fenix-NTM® castor Ottawa 0717

Fenix-NTM® gris Londres 0718

Fenix-NTM® noir Ingo 0720

Notes:

Traverses sous-plateau en aluminium anodisé

Emballages renforcés, voir intérieur de la couverture.

Code	Longueur	Pieds	Plateau	colis	m ³	Kg
			Fenix-NTM®			
01BEA01F	123	Laqué		1	0,27	33
01BEA02F	150	Laqué		1	0,32	38

Optionals

Code	Description	colis	m ³	Kg
02GTA02	Coupe des pieds sur mesure	-	-	-
02FOR03	Passe-câbles latérale ou central Ø6	-	-	-
02RET09	Câblage, matière plastique	1	0,07	1
02VER01	Vertèbre, méthacrylate opaline	1	0,007	1,5
02CPU07	Support CPU, méthacrylate opaline	1	0,14	5,5

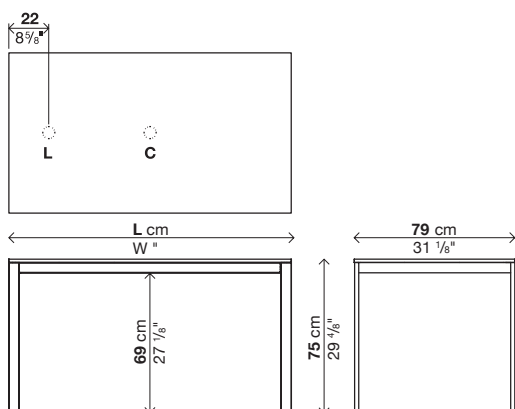

BE-EASY

Extensible - Profondeur 89 cm

Finition piètement:

Acier laqué blanc (semblable à la teinte RAL 9016)

Acier laqué "Fenix-NTM® castor Ottawa" (semblable à la teinte RAL Design0805010)

Acier laqué "Fenix-NTM® gris Londres" (semblable à la teinte RAL Design0805005)

Acier laqué noir (semblable à la teinte RAL 9004)

Notes:

Traverses sous-plateau en aluminium anodisé

Emballages renforcés, voir intérieur de la couverture.

Finition du plateau/rallonges:

Fenix-NTM® blanc Kos 0032

Fenix-NTM® castor Ottawa 0717

Fenix-NTM® gris Londres 0718

Fenix-NTM® noir Ingo 0720

Code	Longueur	Pieds	Plateau	colis	m ³	Kg
			Fenix-NTM®			
01BEA05	150-190-230	Laqué		1	0,36	62
01BEA03	170-210-250	Laqué		1	0,37	76

Optionals

Code	Description	colis	m ³	Kg
02GTA02	Coupe des pieds sur mesure	-	-	-

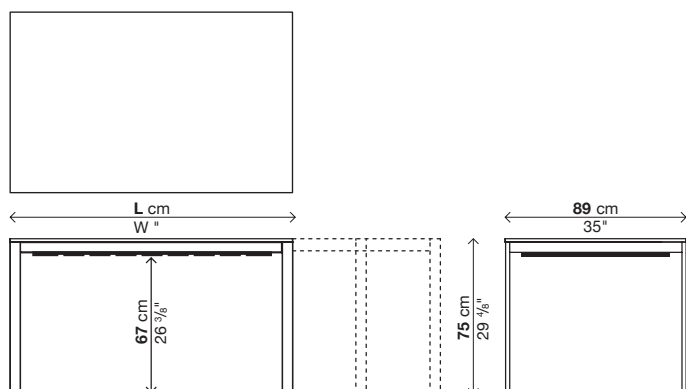

BE-EASY

Fixe - Profondeur 89 cm

Finition piètement:

Acier laqué blanc (semblable à la teinte RAL 9016)

Acier laqué "Fenix-NTM® castor Ottawa" (semblable à la teinte RAL Design0805010)

Acier laqué "Fenix-NTM® gris Londres" (semblable à la teinte RAL Design0805005)

Acier laqué noir (semblable à la teinte RAL 9004)

Finition du plateau:

Fenix-NTM® blanc Kos 0032

Fenix-NTM® castor Ottawa 0717

Fenix-NTM® gris Londres 0718

Fenix-NTM® noir Ingo 0720

Notes:

Traverses sous-plateau en aluminium anodisé

Emballages renforcés, voir intérieur de la couverture.

Code	Longueur	Pieds	Plateau	colis	m ³	Kg
			Fenix-NTM®			
01BEA05F	150	Laqué		1	0,36	40
01BEA03F	170	Laqué		1	0,37	45

Optionals

Code	Description	colis	m ³	Kg
02GTA02	Coupe des pieds sur mesure	-	-	-
02FOR03	Passe-câbles latérale ou central Ø6	-	-	-
02RET02	Câblage, matière plastique	1	0,07	1
02VER01	Vertèbre, méthacrylate opaline	1	0,007	1,5
02CPU08	Support CPU, méthacrylate opaline	1	0,14	5,5

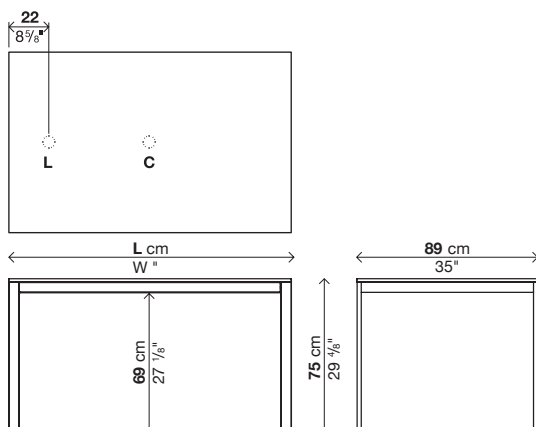

BE-EASY

Extensible - Profondeur 99 cm

Finition piètement:

Acier laqué blanc (semblable à la teinte RAL 9016)

Acier laqué "Fenix-NTM® castor Ottawa" (semblable à la teinte RAL Design0805010)

Acier laqué "Fenix-NTM® gris Londres" (semblable à la teinte RAL Design0805005)

Acier laqué noir (semblable à la teinte RAL 9004)

Finition du plateau/rallonges:

Fenix-NTM® blanc Kos 0032

Fenix-NTM® castor Ottawa 0717

Fenix-NTM® gris Londres 0718

Fenix-NTM® noir Ingo 0720

Notes:

Traverses sous-plateau en aluminium anodisé

Emballages renforcés, voir intérieur de la couverture.

Code	Longueur	Pieds	Plateau	colis	m ³	Kg
			Fenix-NTM®			
01BEA04	200-240-280	Laqué		1	0,5	76

Optionals

Code	Description	colis	m ³	Kg
02GTA02	Coupe des pieds sur mesure	-	-	-

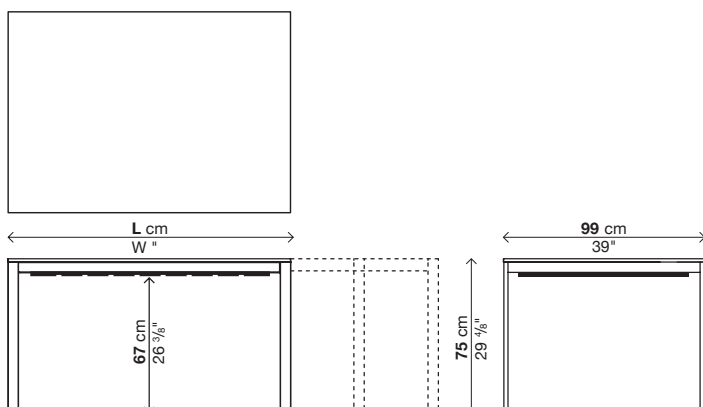

BE-EASY

Fixe - Profondeur 99 cm

Finition piètement:

Acier laqué blanc (semblable à la teinte RAL 9016)

Acier laqué "Fenix-NTM® castor Ottawa" (semblable à la teinte RAL Design0805010)

Acier laqué "Fenix-NTM® gris Londres" (semblable à la teinte RAL Design0805005)

Acier laqué noir (semblable à la teinte RAL 9004)

Finition du plateau:

Fenix-NTM® blanc Kos 0032

Fenix-NTM® castor Ottawa 0717

Fenix-NTM® gris Londres 0718

Fenix-NTM® noir Ingo 0720

Notes:

Traverses sous-plateau en aluminium anodisé

Emballages renforcés, voir intérieur de la couverture.

Code	Longueur	Pieds	Plateau	colis	m ³	Kg
			Fenix-NTM®			
01BEA04F	200	Laqué		1	0,5	58

Optionals

Code	Description	colis	m ³	Kg
02GTA02	Coupe des pieds sur mesure	-	-	-
02FOR03	Passe-câbles latérale ou central Ø6	-	-	-
02RET03	Câblage, matière plastique	1	0,07	1
02VER01	Vertèbre, méthacrylate opaline	1	0,007	1,5

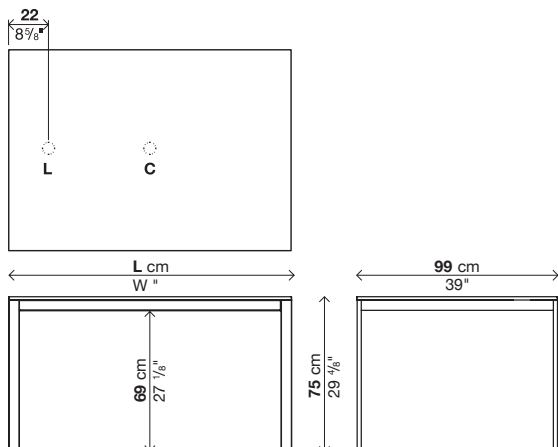

BE-EASY

Dimensiones

Prof. 79 cm
Depth 31 1/8"

79

123 cm 48 3/8"

 → Fenix-NTM®

123/163/203 cm 48 3/8/64 1/8/79"

 → Fenix-NTM®

150 cm 59"

 → Fenix-NTM®

150/190/230 cm 59/74 1/8/90 1/2"

 → Fenix-NTM®

Prof. 89 cm
Depth 35"

89

150 cm 59"

 → Fenix-NTM®

150/190/230 cm 59/74 1/8/90 1/2"

 → Fenix-NTM®

170 cm 66 7/8"

 → Fenix-NTM®

170/210/250 cm 66 7/8/82 3/4/98 3/8"

 → Fenix-NTM®

Prof. 99 cm
Depth 39"

88

200 cm 78 3/8"

 → Fenix-NTM®

200/240/280 cm 78 3/4/94 1/2/110 2/8"
--

 → Fenix-NTM®

Sobres Esp. 17 mm

Fenix-NTM®

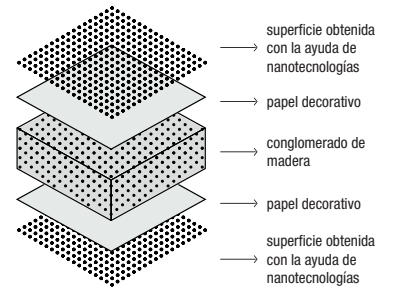
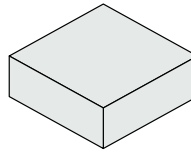

BE-EASY

Extensible - Profundidad 79 cm

Acabado patas:

Acero barnizado blanco (parecido al RAL 9016)

Acero barnizado "Fenix-NTM® castor Ottawa" (parecido al RAL Design0805010)

Acero barnizado "Fenix-NTM® gris Londres" (parecido al RAL Design0805005)

Acero barnizado negro (parecido al RAL 9004)

Acabado sobre/prolongaciones:

Fenix-NTM® blanco Kos 0032

Fenix-NTM® castor Ottawa 0717

Fenix-NTM® gris Londres 0718

Fenix-NTM® negro Ingo 0720

Notas:

Barras bajo el sobre de aluminio anodizado.

Embalajes reforzados, ver lado interno de la portada.

Código	Longitud	Patas	Sobre	pack	m ³	Kg
			Fenix-NTM®			
01BEA01	123-163-203	Barnizado		1	0,27	47
01BEA02	150-190-230	Barnizado		1	0,32	53

Opcionales

Código	Descripción	pack	m ³	Kg
02GTA02	Corte pata a medida	-	-	-

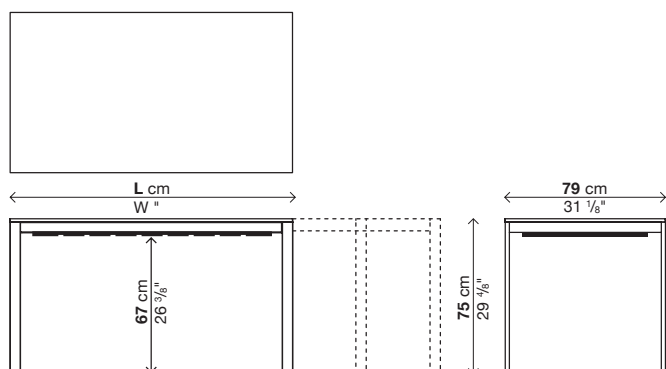

BE-EASY

Fija - Profundidad 79 cm

Acabado patas:

Acero barnizado blanco (parecido al RAL 9016)

Acero barnizado "Fenix-NTM® castor Ottawa" (parecido al RAL Design0805010)

Acero barnizado "Fenix-NTM® gris Londres" (parecido al RAL Design0805005)

Acero barnizado negro (parecido al RAL 9004)

Acabado sobre:

Fenix-NTM® blanco Kos 0032

Fenix-NTM® castor Ottawa 0717

Fenix-NTM® gris Londres 0718

Fenix-NTM® negro Ingo 0720

Notas:

Barras bajo el sobre de aluminio anodizado.

Embalajes reforzados, ver lado interno de la portada.

Código	Longitud	Patas	Sobre	pack	m ³	Kg
			Fenix-NTM®			
01BEA01F	123	Barnizado		1	0,27	33
01BEA02F	150	Barnizado		1	0,32	38

Opcionales

Código	Descripción	pack	m ³	Kg
02GTA02	Corte pata a medida	-	-	-
02FOR03	Orificio guiacables lateral o central Ø6	-	-	-
02RET09	Red de cable de plástico	1	0,07	1
02VER01	Vértebra, metacrilato opalino	1	0,007	1,5
02CPU07	Porta CPU, metacrilato opalino	1	0,14	5,5

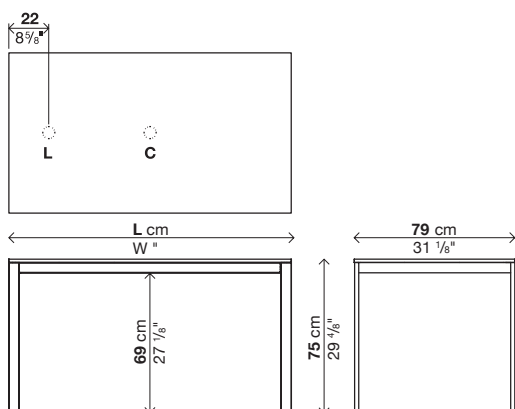

BE-EASY

Extensible - Profundidad 89 cm

Acabado patas:

Acero barnizado blanco (parecido al RAL 9016)

Acero barnizado "Fenix-NTM® castor Ottawa" (parecido al RAL Design0805010)

Acero barnizado "Fenix-NTM® gris Londres" (parecido al RAL Design0805005)

Acero barnizado negro (parecido al RAL 9004)

Acabado sobre/prolongaciones:

Fenix-NTM® blanco Kos 0032

Fenix-NTM® castor Ottawa 0717

Fenix-NTM® gris Londres 0718

Fenix-NTM® negro Ingo 0720

Notas:

Barras bajo el sobre de aluminio anodizado.

Embalajes reforzados, ver lado interno de la portada.

Código	Longitud	Patas	Sobre	pack	m ³	Kg
			Fenix-NTM®			
01BEA05	150-190-230	Barnizado		1	0,36	62
01BEA03	170-210-250	Barnizado		1	0,37	76

Opcionales

Código	Descripción	pack	m ³	Kg
02GTA02	Corte pata a medida	-	-	-

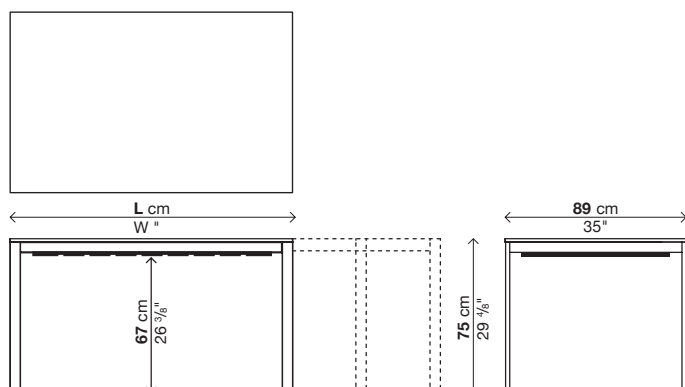

BE-EASY

Fija - Profundidad 89 cm

Acabado patas:

Acero barnizado blanco (parecido al RAL 9016)

Acero barnizado "Fenix-NTM® castor Ottawa" (parecido al RAL Design0805010)

Acero barnizado "Fenix-NTM® gris Londres" (parecido al RAL Design0805005)

Acero barnizado negro (parecido al RAL 9004)

Acabado sobre:

Fenix-NTM® blanco Kos 0032

Fenix-NTM® castor Ottawa 0717

Fenix-NTM® gris Londres 0718

Fenix-NTM® negro Ingo 0720

Notas:

Barras bajo el sobre de aluminio anodizado.

Embalajes reforzados, ver lado interno de la portada.

Código	Longitud	Patas	Sobre	pack	m ³	Kg
			Fenix-NTM®			
01BEA05F	150	Barnizado		1	0,36	40
01BEA03F	170	Barnizado		1	0,37	45

Opcionales

Código	Descripción	pack	m ³	Kg
02GTA02	Corte pata a medida	-	-	-
02FOR03	Orificio guiacables lateral o central Ø6	-	-	-
02RET02	Red de cable de plástico	1	0,07	1
02VER01	Vértebra, metacrilato opalino	1	0,007	1,5
02CPU08	Porta CPU, metacrilato opalino	1	0,14	5,5

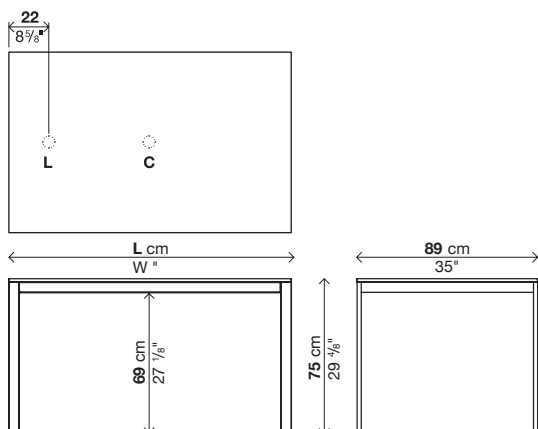

BE-EASY

Extensible - Profundidad 99 cm

Acabado patas:

Acero barnizado blanco (parecido al RAL 9016)

Acero barnizado "Fenix-NTM® castor Ottawa" (parecido al RAL Design0805010)

Acero barnizado "Fenix-NTM® gris Londres" (parecido al RAL Design0805005)

Acero barnizado negro (parecido al RAL 9004)

Acabado sobre/prolongaciones:

Fenix-NTM® blanco Kos 0032

Fenix-NTM® castor Ottawa 0717

Fenix-NTM® gris Londres 0718

Fenix-NTM® negro Ingo 0720

Notas:

Barras bajo el sobre de aluminio anodizado.

Embalajes reforzados, ver lado interno de la portada.

Código	Longitud	Patas	Sobre	pack	m ²	Kg
			Fenix-NTM®			
01BEA04	200-240-280	Barnizado		1	0,5	76

Opcionales

Código	Descripción	pack	m ²	Kg
02GTA02	Corte pata a medida	-	-	-

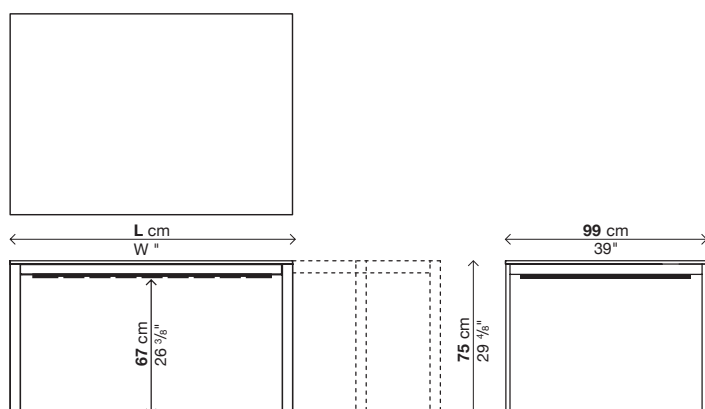

BE-EASY

Fija - Profundidad 99 cm

Acabado patas:

Acero barnizado blanco (parecido al RAL 9016)

Acero barnizado "Fenix-NTM® castor Ottawa" (parecido al RAL Design0805010)

Acero barnizado "Fenix-NTM® gris Londres" (parecido al RAL Design0805005)

Acero barnizado negro (parecido al RAL 9004)

Acabado sobre:

Fenix-NTM® blanco Kos 0032

Fenix-NTM® castor Ottawa 0717

Fenix-NTM® gris Londres 0718

Fenix-NTM® negro Ingo 0720

Notas:

Barras bajo el sobre de aluminio anodizado.

Embalajes reforzados, ver lado interno de la portada.

Código	Longitud	Patas	Sobre	pack	m ³	Kg
			Fenix-NTM®			
01BEA04F	200	Barnizado		1	0,5	58

Opcionales

Código	Descripción	pack	m ³	Kg
02GTA02	Corte pata a medida	-	-	-
02FOR03	Orificio guiacables lateral o central Ø6	-	-	-
02RET03	Red de cable de plástico	1	0,07	1
02VER01	Vértebra, metacrilato opalino	1	0,007	1,5

